

## Square High Back Ergonomic Office Chair

### Assembly and Use Instructions



For safety, please follow the instructions in this manual.

This product is one-person-use designed, and indoor use (in office and home). It should not be used outdoors

### Safety Instructions

- This product is one-person-use designed, and indoor use (in office and home). It should not be used outdoors.
- Tighten the bolts and handle bolts of the product once every month.
- When cleaning the product, use a vacuum cleaner or wipe it with soft fabric

**This is important information for the user's safety and for prevention of property damage. Please read carefully to use the product correctly.**

 **Warning** If directions are not followed correctly, it could cause a serious injury or damage property.

 **Caution** If directions are not followed there could be personal injury or property damage.

 **Warning**

#### Use the product for its purpose

- Going to sleep on the product or using it to exercise can cause serious injury including death when the product falls over.

#### Do not lean or stand up on the product

- It could cause a serious injury if the product if the product rolls over

#### Do not lift your legs on a high surface when sitting on the product.

- In case the product slips/falls, It is possible it might cause serious injury and even death

#### Do not lean too far on the product

- In poses a risk of injury if the product falls

#### Do not use excessive force on the armrest.

- There is a risk of injury

#### Do not crawl under the product

- There is a risk of getting injured if the product falls

#### When using the product, sit correctly maintaining correct position

- When leaning on the backrest, seat pan, or the armrest, there is risk of injury

#### When someone is sitting down, do not spin or push

- There is a risk of injury

#### Do not put your hand in the product's gap between parts and the mechanism.

- Your hand can get caught causing injury

## Components

### • Main components

(Make sure if you have all the components beforehand.)

#### Backrest (4 Options)

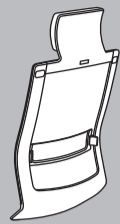

Headrest O /  
Lumbar support O

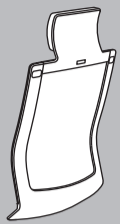

Headrest O /  
Lumbar support X

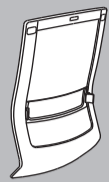

Headrest X /  
Lumbar support O

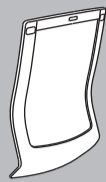

Headrest X /  
Lumbar support X

#### Seatpan (2 Options)



Adjustable  
armrest

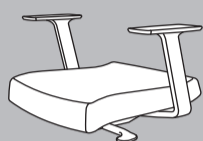

Fixed  
armrest

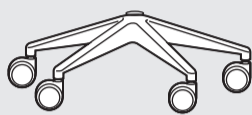

5 Star Base  
5 Castors

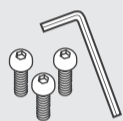

3 Bolts(M6x16mm) X 1 Wrench



Gas cylinder



Manual

### Material

Structural: Steel, Synthetic resins

Cushioning: Urethane foam

Surface: Polyester 100%

## How to Assemble

**1** Remove red cap on the top of the gas cylinder and insert it to the center hole of the base.

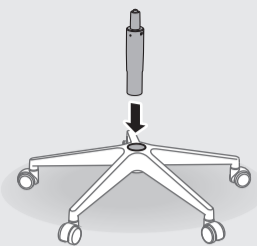

**2** Assemble backrest with seatpan.

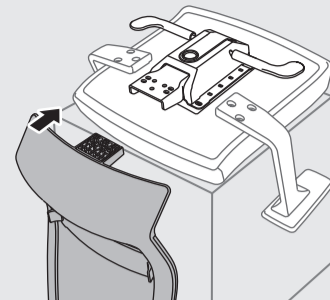

**3** Tighten the 3 bolts firmly with wrench.

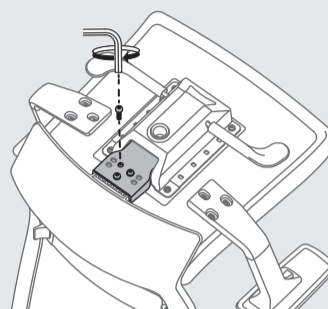

**4** Insert the chair body onto the gas cylinder.



**5** Assembly complete.

## SPEC

### Specification

W (Seat width)  
D (Seat depth)  
H (Chair height)

Fixed  
armrest



Adjustable  
armrest



## How to Use

### Adjusting Seat Height

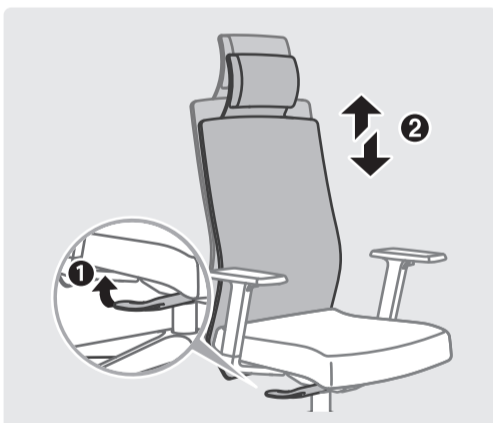

Pull the lever on the right hand side while sitting (1), and release the lever on desired position (2).

- To raise: Raise your body off the chair.
- To lower: Remain seated

### Adjusting Armrest Height

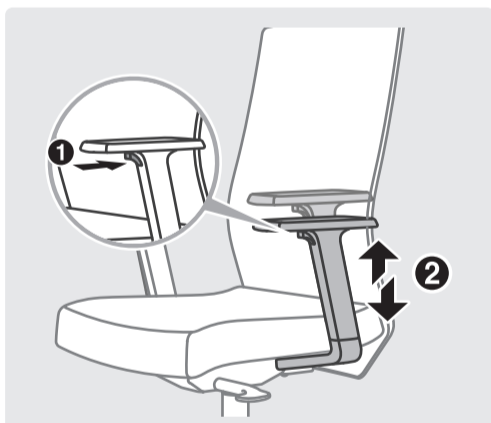

While pressing the armrest height adjustment button (1), and release the button on desired position (2).

**Q FYI** Adjustable armrest only.

### Adjustable Tilting Angle

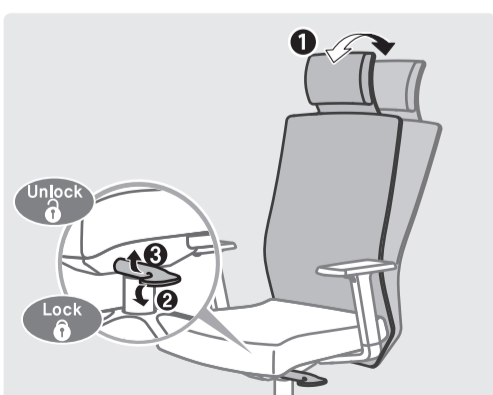

Pull the lever on the left hand side (1), and recline to desired position (1~3 stages) (2).

**Q FYI** If you want to turn it back to the original position, lean back while lifting the lever. Then, the chair will be returned to the original position.

### Adjusting Headrest Height

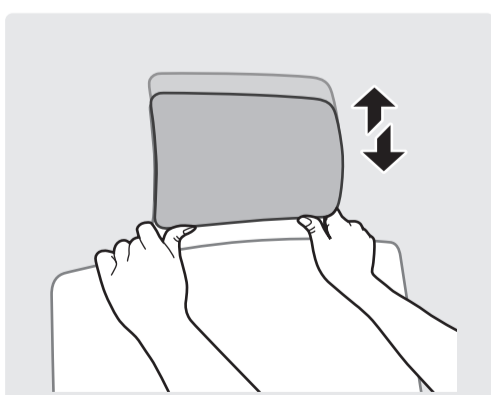

Push it up on desired position. Or press it down until desired position.

**Q FYI** Backrest with Headrest only.

## How to Use

### Adjusting Lumbar Support Height

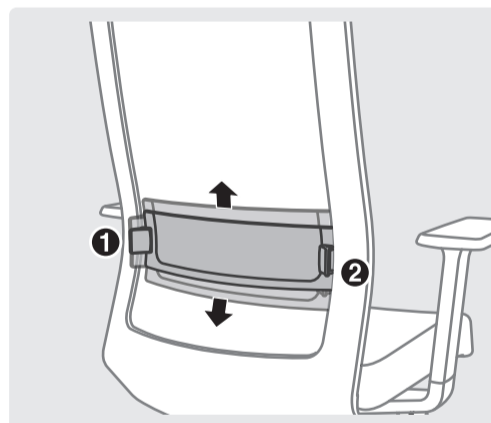

Unlck the both lever (1, 2) outside and move up and down to adjust height.

**Q FYI** Backrest with Lumbar Support only

### Adjusting Lumbar Support Tension

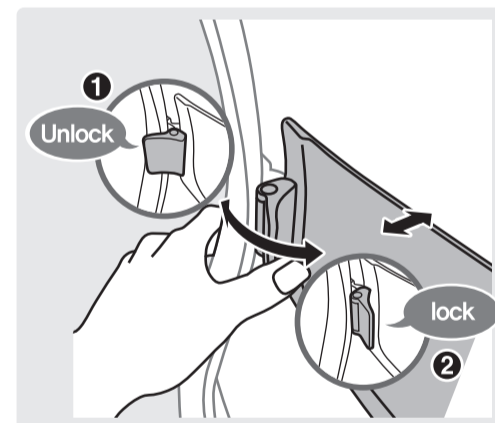

Lock/unlock the both lever (1, 2) inside / outside for tension.

### Adjusting Seat Depth



pull the lever on the left-hand side and release the lever at desired position.